



JOHN DEERE

Product Services Information

INSTALLATION INSTRUCTIONS

(Includes English, French, German, Spanish and Italian)



JOHN DEERE

WEIGHT BRACKET KIT

Parts in Kit

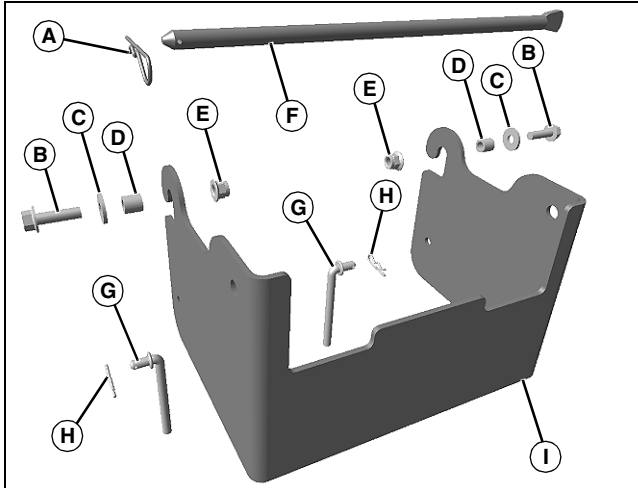

MX30992

Qty.	Description
1	Quick-Pull Hairpin (A)
2	Bolt, Flange, M10x35 (B)
2	Washer, 0.406x1.062x0.120 in. (C)
2	Spacer (D)
2	Locknut, Flange, M10 (E)
1	Weight Bracket Retaining Rod (F)
2	Drilled Clevis Pin, M10x16 (G)
2	Spring Locking Pin (H)
1	Weight Bracket (I)

NOTE: Retain these installation instructions with the machine operator's manual.

Install Mounting Frame

NOTE: If rear bagger is already installed, steps one and two do not need to be completed and hardware used in those steps can be discarded. When bagger is removed, current bagger mounting hardware can be used to mount weight bracket.

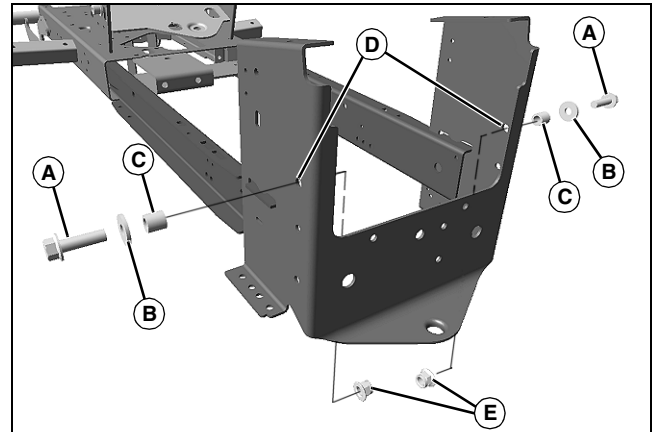

MX31012

1. Install two M10x35 bolts (A), 0.406x1.062x0.120 in. flat washers (B), and spacers (C) at top holes (D) in rear frame.
2. Install M10 locknuts (E) on bolts from inside of rear frame. Tighten nuts completely.

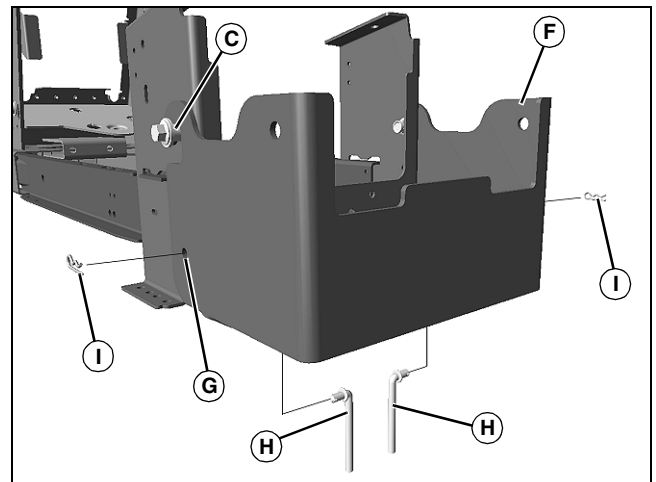

MX31013

3. Hang weight bracket (F) on spacer (C) at each side of rear frame.
4. Align lower holes (G) in weight bracket with bottom holes in rear frame.
5. From inside of rear frame, insert two M10x16 drilled clevis pins (H) through holes in weight bracket. Secure with two small spring locking pins (I).

Install Rear Weights (Not Included)

NOTE: Rear weight bracket holds two weights, not included in kit. Weights shown in photo to show position only.

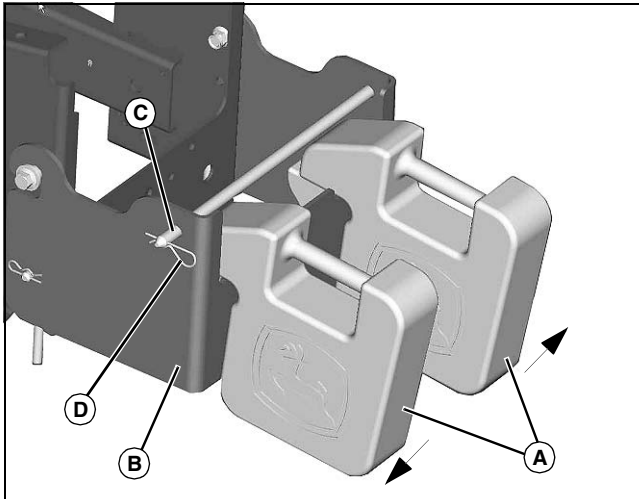

MX31014

1. Install weights (A) in outer slots on bracket (B).
2. Install retaining rod (C) through top holes of bracket, and fasten retaining rod with quick pull pin (D).